

SUGGESTED PCB LAYOUT

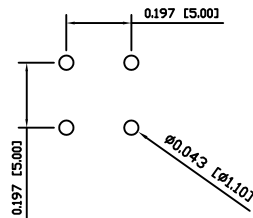

SCHMATIC

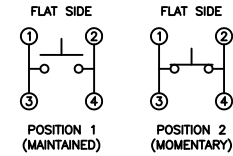

SPECIFICATIONS

FUNCTION:
1P1T OFF-(ON)

RATINGS:
10mA 35VDC

OPERATION FORCE:
130±40gf

CONTACT RESISTANCE:
Initial: 20mΩ Max.

INSULATION RESISTANCE:
100MΩ Min. at 500VDC

DIELECTRIC STRENGTH:
500VAC For 1 Minute

CAPACITANCE:
1pF

ELECTRICAL LIFE:
250,000 Cycles

MECHANICAL LIFE:
500,000 Cycles Min.

TEMPERATURE:
Operating: -20°C to 85°C

APPROVALS:
RoHS
COMPLIANT

MATERIALS

UPPER HOUSING:
Acrylonitrile Butadiene Styrene (ABS)

LOWER HOUSING:
Polybutylene Terephthalate (PBT)

CONTACTS:
Silver Plated Copper

TERMINALS:
Silver Plated Brass

COLORS

UPPER HOUSING COLOR:
Green

LOWER HOUSING COLOR:
White

| | | | |
|----------------|------|----------|-----|
| BODY | A | 09/06/06 | CAB |
| COLORS | A | 09/06/06 | CAB |
| MATERIALS | A | 09/06/06 | CAB |
| SPECIFICATIONS | A | 09/06/06 | CAB |
| REFERENCE | REV. | DATE | BY |

THE INFORMATION CONTAINED IN THIS DOCUMENT IS PROPRIETARY TO E-SWITCH AND IS NOT TO BE COPIED OR TRANSFERRED

| | | | | |
|------|-----------------|----------|----------|----------|
| A | INITIAL RELEASE | PCRD0051 | 09/06/06 | CAB |
| REV. | DESCRIPTION | PCR | DATE | DRAWN BY |

| | |
|--------------------|----------------------|
| DIMENSIONS | INCHES [MILLIMETERS] |
| GENERAL TOLERANCES | ±0.008 [±0.2] / ±1° |
| SCALE | DRAWING NOT TO SCALE |

| | | |
|----------------|----------------|----------|
| | | |
| KS-01Q-03 | | |
| DRAWING NUMBER | DATE | REVISION |
| 29-KS01Q03 | AUGUST 6, 2009 | A |