

THIS DRAWING IS UNPUBLISHED. RELEASED FOR PUBLICATION 20
 © COPYRIGHT 20 BY - ALL RIGHTS RESERVED.

REVISIONS				
P	LTR	DESCRIPTION	DATE	APVD
A1		REVISED PER ECO-10-001873	19FEB2010	DH JE
A2		REVISED PER ECO-15-004981	31MAR2015	RG MC

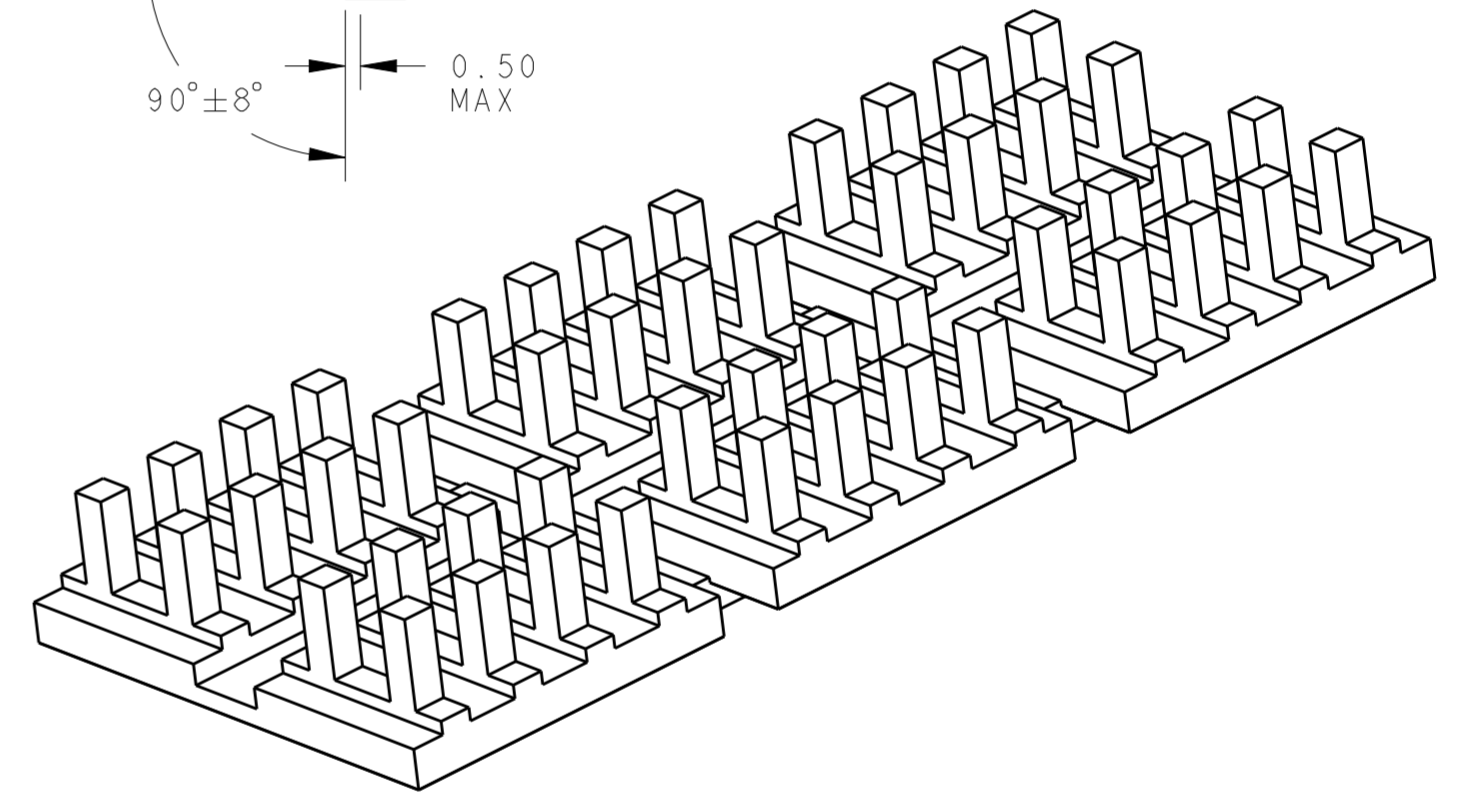
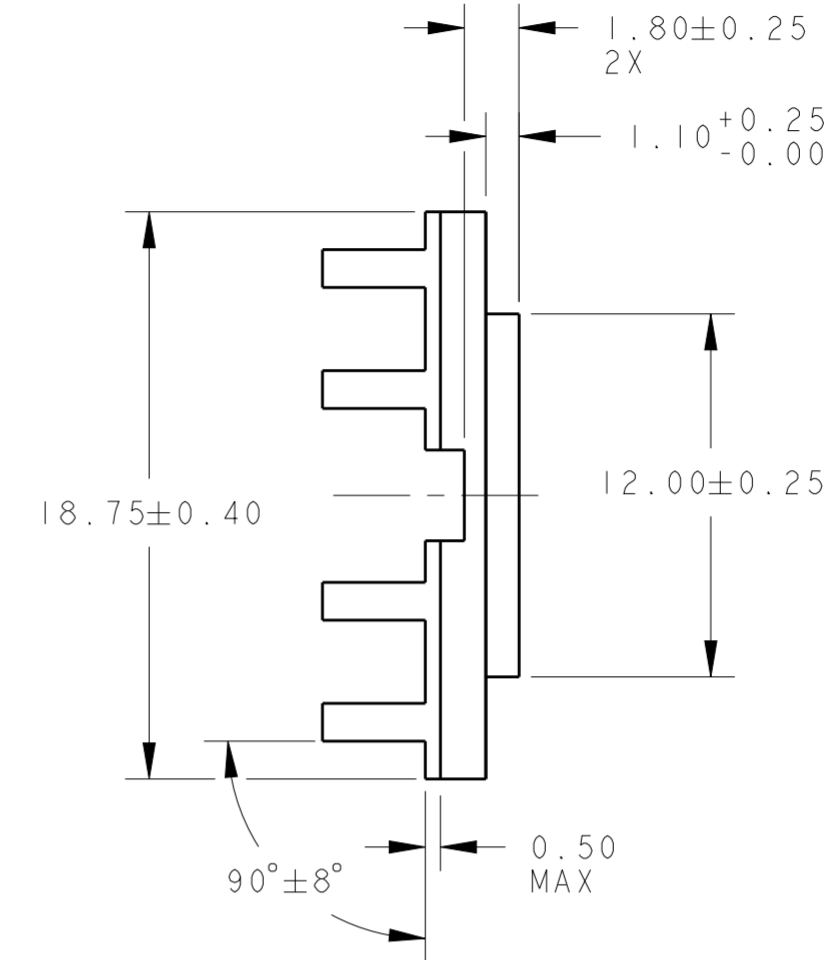
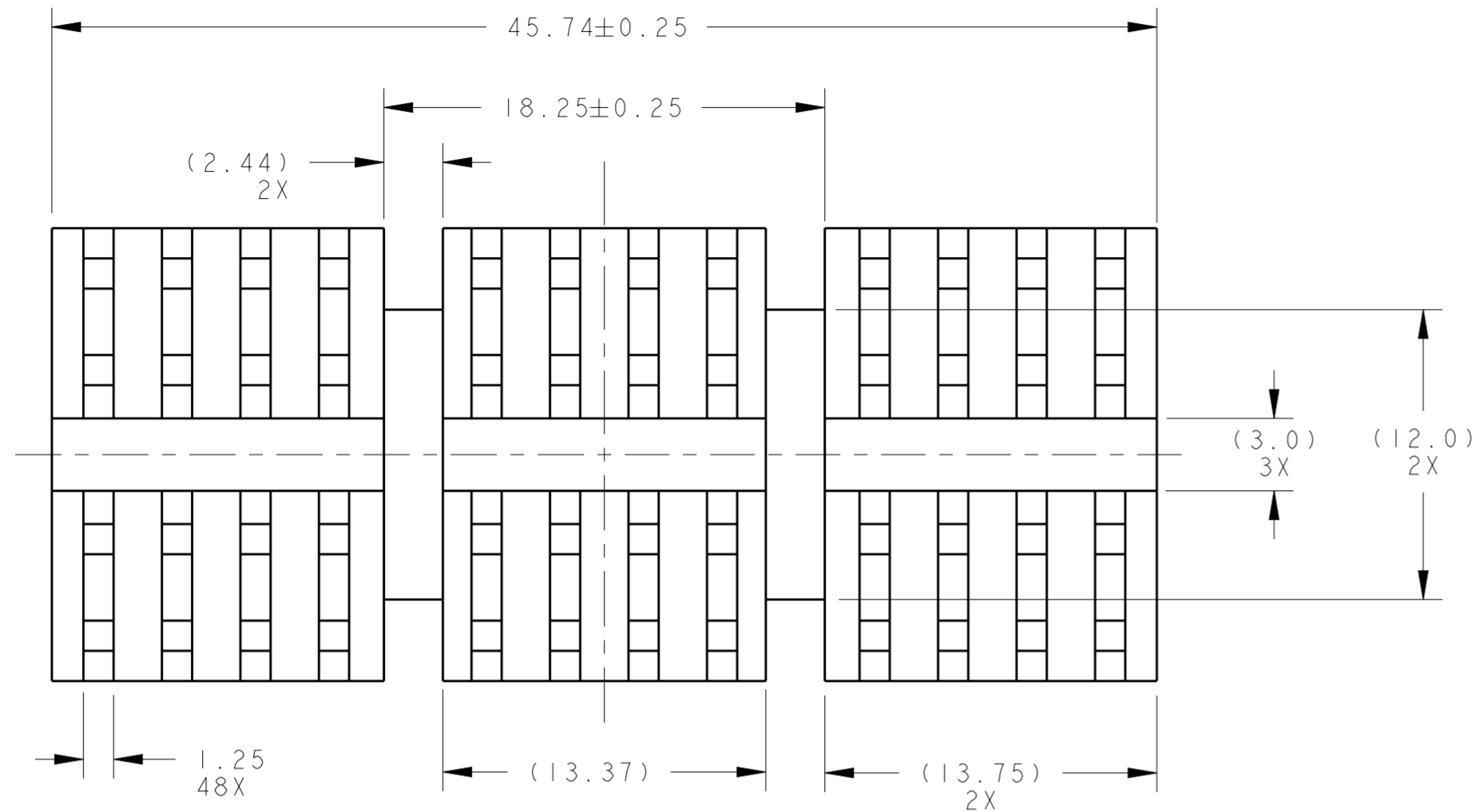

NOTES:

- UNLESS OTHERWISE SPECIFIED
- 1. INTERPRET DRAWING PER ASME Y14.5M - 1994.
- 2. 0,2mm MAX BURR.
- 3. VARIATION IN PLATING COLOR IS NORMAL AND ALLOWED.
- 4. RoHS COMPLIANT AND CERTIFIED.

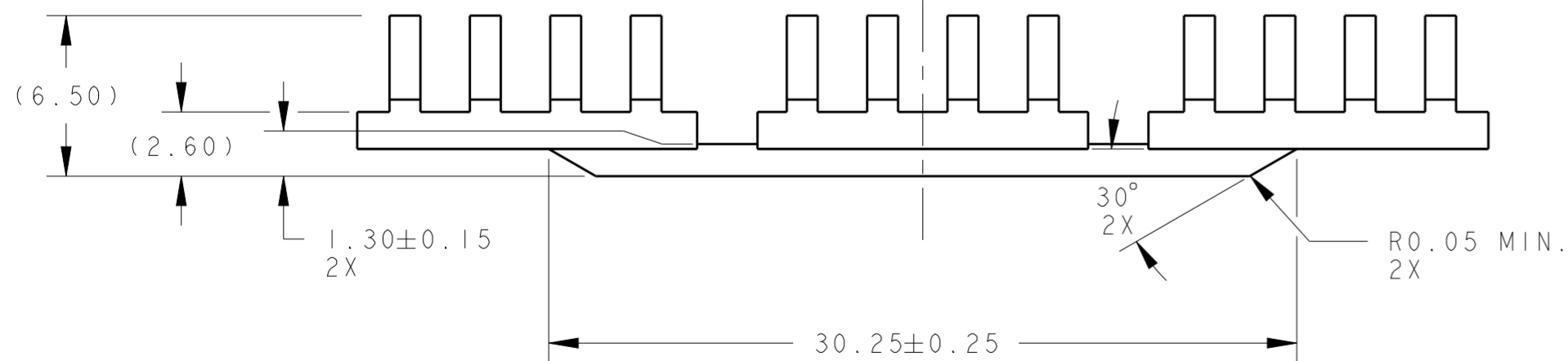

FINISH	MATERIAL	PART NUMBER
BLACK ANODIZED	ALUMINUM	1963842-5
NICKEL PLATED	ALUMINUM	1963842-3
NONE	ALUMINUM	1963842-1

THIS DRAWING IS A CONTROLLED DOCUMENT.		DWN E. TAO 6-17-08	TE Connectivity	
		CHK B. PETROCELLI 6-23-08		
DIMENSIONS: mm	TOLERANCES UNLESS OTHERWISE SPECIFIED:	APVD -	NAME QSFP SINGLE SAN EXTRUSION HEATSINK 6.5mm TALL	
0 PLC ±	1 PLC ±0.2	PRODUCT SPEC -	SIZE A2	
2 PLC ±0.10	3 PLC ±0.08	APPLICATION SPEC -	CAGE CODE C-1963842	DRAWING NO 1963842
4 PLC ±	ANGLES ±5°	WEIGHT -	RESTRICTED TO -	SCALE 4.000
MATERIAL SEE TABLE	FINISH SEE TABLE	CUSTOMER DRAWING	SHEET 1	OF 1
			REV A2	