

STANDARD CRIMP

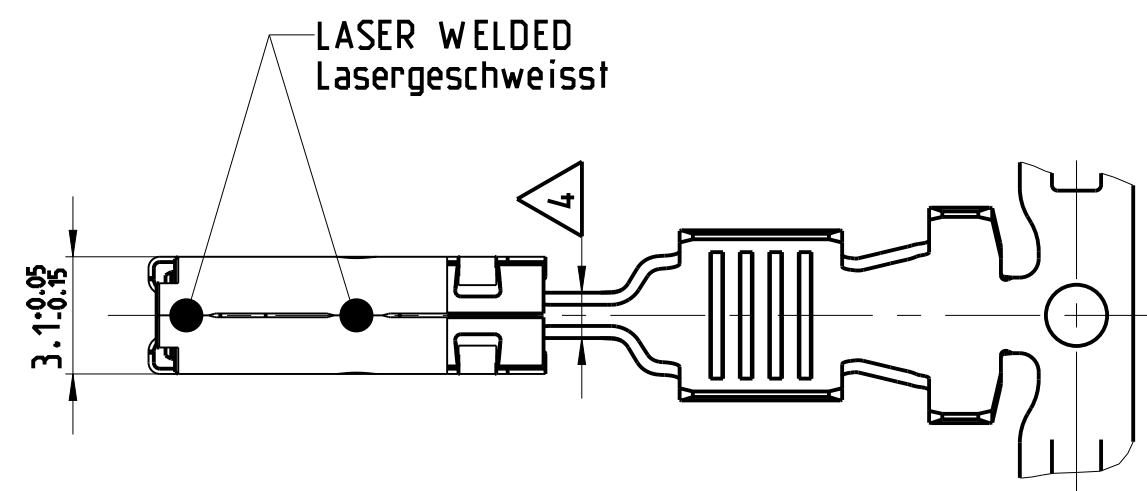

ONLY FOR WIRE SIZE RANGE
 Nur fuer DGB
 0.2 ... 0.5 mm²

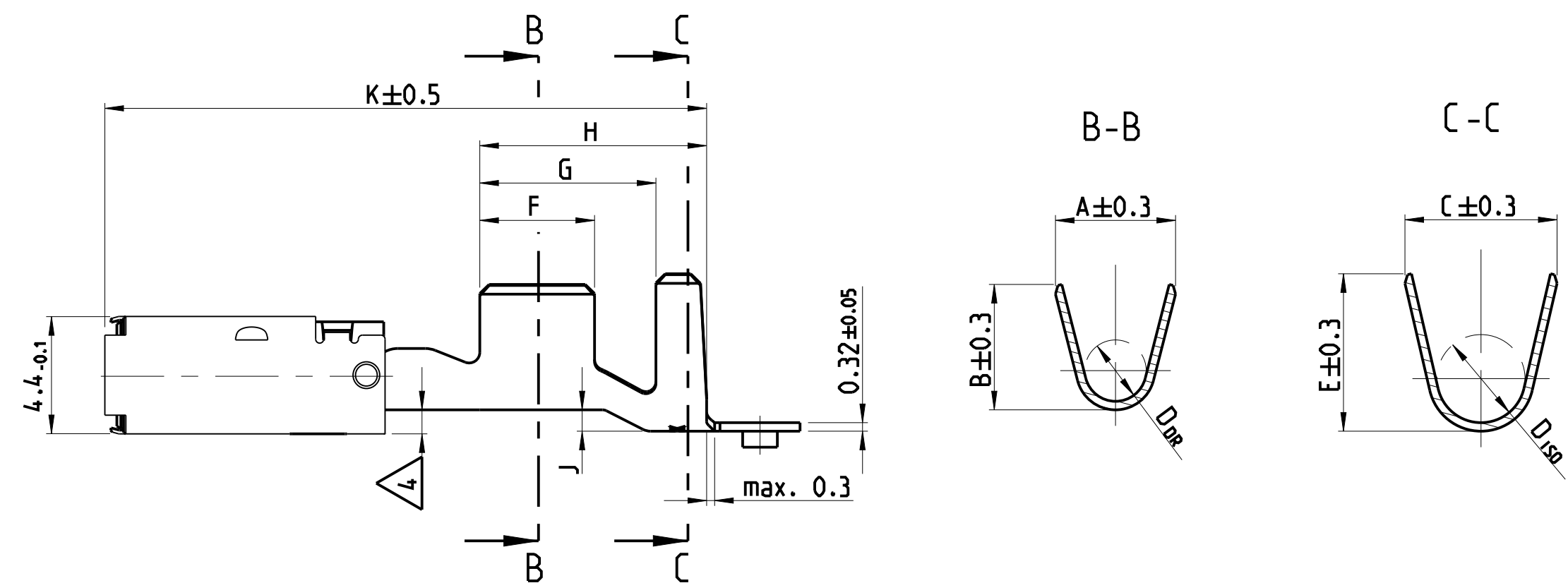
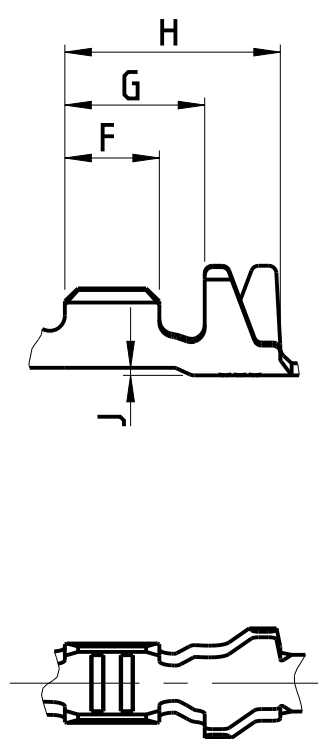

SINGLE WIRE SEAL Einzeldichtungssystem

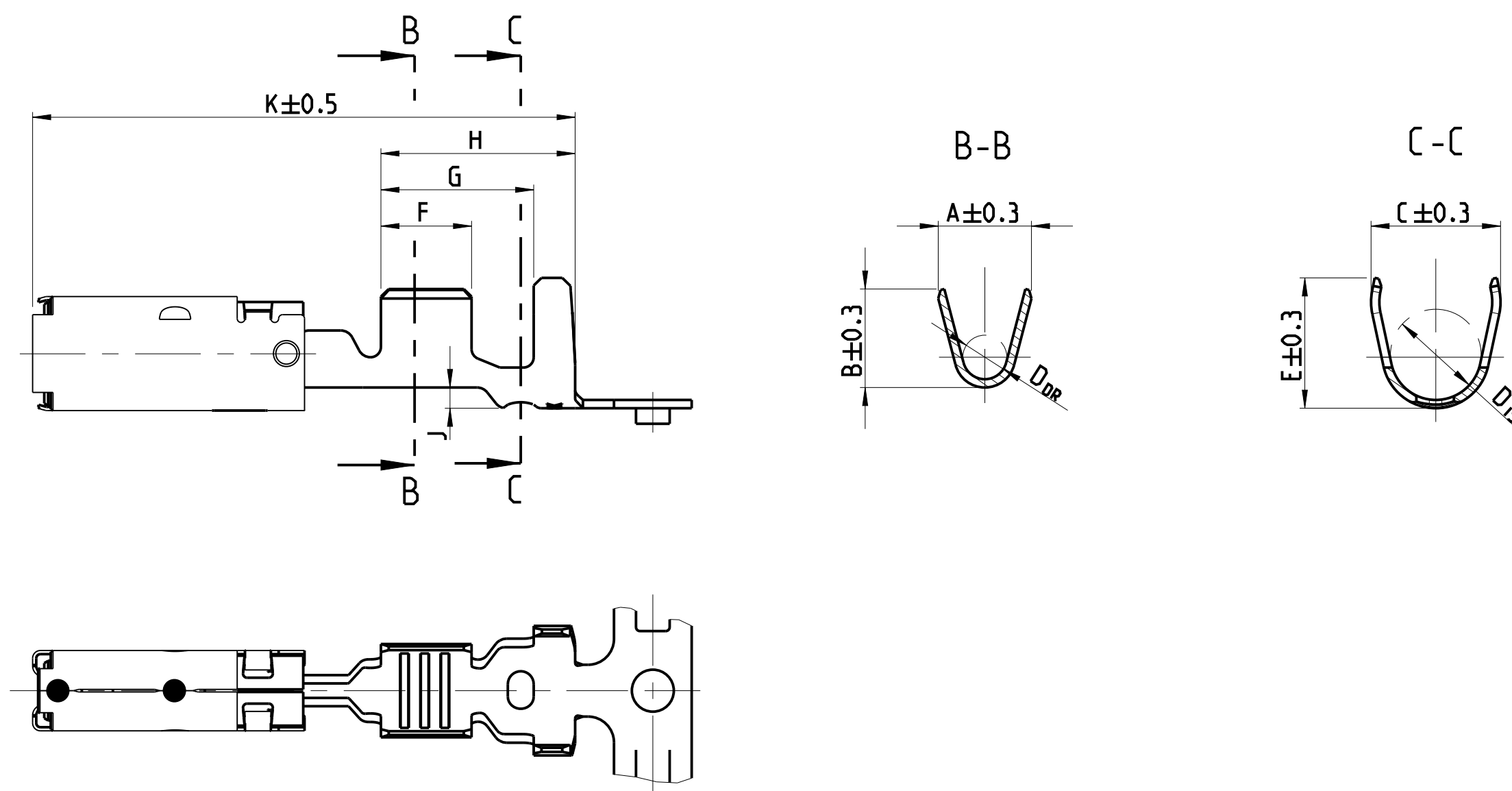

REVISIONS				
P	LTR	DESCRIPTION	DATE	APPD
A1		SWS ADDED. NEW 3D DWG CREATED	17APR2014	Bren Leim
A2		PN 1-2282364-3 ADDED TO DRAWING	02SEP2014	Joas Leim

NOTES Bemerkungen

- MATING PART SEE INTERFACE DRAWING
 TE-NO.: 114-18230-002
 Gegenstecker nach Ausfuehrungsvorschrift
 TE-Nr.: 114-18230-002
- 2** SURFACE:
 - PRE TIN PLATED 1 TO 3µm
 - SILVER PLATED 3 TO 5µm (ONLY CONTACT AREA)
 Oberflaeche:
 - verzinkt 1 bis 3µm
 - versilbert 3 bis 5µm (nur Kontaktzone)
- DOUBLE CRIMPS ARE ONLY POSSIBLE WITH APPLICATORS AUTHORIZED BY TE (NO HAND TOOL) SUITABLE TOOLS ON REQUEST
 Doppelanschlage sind nur mit von TE zugelassenen Anschlagwerkzeugen moeglich (keine Handzangen) passende Werkzeuge auf Anfrage
- 4** GAUGE INSPECTION
 Lehrenpruefung
- DETAILS OF DESIGN ARE LEFT TO MANUFACTURER
 Einzelheiten der Ausfuehrung bleiben dem Hersteller ueberlassen
- ONLY GERMAN LANGUAGE VERSION SHALL BE BINDING
 Massgebend ist der deutsche Text

VERSION	ORDER-NO. STRIP-FORM	REV	BODY	MATERIAL	SURFACE	WIRE SIZE RANGE	INSULATION DIAMETER	CRIMP DIMENSIONS / Crimpabmessungen mm											WEIGHT	SINGLE WIRE SEAL	TE CONNECTIVITY NO.	TE CONNECTIVITY NO.
								A	B	D _{DR}	C	E	D _{ISO}	F	G	H	J	K				
SINGLE WIRE SEAL Einzeldichtung	1-2282365-1	A	CuNiSi	X10CrNi18-8	PRE TIN PLATED verzinkt	12 AWG	3.0 - 3.8	4.0	4.2	2.0	5.0	5.0	3.5	3.5	5.9	7.5	0.8	21.0	0.60	828905-1	828922-1	
	1-2282364-3	A			SILVER PLATED versilbert	1.5 - 2.5	2.2 - 3.0	3.6	3.8	1.7	5.0	5.0	3.5	3.5	5.9	7.5	0.8	21.0	0.59	828905-1	828922-1	
	1-2282364-1	A			PRE TIN PLATED verzinkt	0.5 - 1.0	1.4 - 2.1	2.5	2.7	1.2	3.3	3.5	1.8	3.0	4.6	6.2	0.2	20.2	0.53	-	-	
	1-1355880-1	D			PRE TIN PLATED verzinkt	0.2 - 0.5	1.2 - 1.4	2.1	2.1	0.8	2.9	2.9	1.4	2.5	3.7	5.7	0.2	20.2	0.50	-	-	
STANDARD CRIMP	1-1355877-1	D	CuNiSi	X10CrNi18-8	PRE TIN PLATED verzinkt	4	2.7 - 3.7	4.5	4.7	2.3	5.7	5.9	3.3	4.3	6.6	8.5	0.8	22.6	0.66	-	-	
	1-1355833-1	D			PRE TIN PLATED verzinkt	0.5 - 1.0	1.4 - 2.1	2.5	2.7	1.2	3.3	3.5	1.8	3.0	4.6	6.2	0.2	20.2	0.53	-	-	
	1-1355876-1	D			PRE TIN PLATED verzinkt	0.2 - 0.5	1.2 - 1.4	2.1	2.1	0.8	2.9	2.9	1.4	2.5	3.7	5.7	0.2	20.2	0.50	-	-	
	1-1355877-1	D			PRE TIN PLATED verzinkt	1.5 - 2.5	2.2 - 3.0	3.6	3.8	1.7	4.6	4.8	2.6	3.5	5.1	6.7	0.3	20.2	0.57	-	-	

SEE APPLICATION SPECIFICATION 114-18148
 siehe Verarbeitungsspezifikation 114-18148

VERSION	ORDER-NO. STRIP-FORM	REV	BODY	MATERIAL	SURFACE	WIRE SIZE RANGE	INSULATION DIAMETER	A	B	D _{DR}	C	E	D _{ISO}	F	G	H	J	K	WEIGHT	SINGLE WIRE SEAL	TE CONNECTIVITY NO.	TE CONNECTIVITY NO.	APPLICATION TOOLS					
Ausfuehrung	Bestell-Nr. Bandware		Werkstoff		Oberflaeche	Leiter-quer-schnitt	Isolations-durchmesser												g	Einzeldichtung			Verarbeitungswerkzeuge					
						mm ²	mm	CRIMP DIMENSIONS / Crimpabmessungen mm																				

THIS DRAWING IS A CONTROLLED DOCUMENT.

DIMENSIONS: mm

TOLERANCES UNLESS OTHERWISE SPECIFIED: ±0.2

0-PLC * * * * *

1-PLC * * * * *

2-PLC * * * * *

3-PLC * * * * *

4-PLC * * * * *

ANGLES FINISH

Customer Drawing

SCALE 5:1 SHEET 1 OF 1 REV A2

THIS DRAWING IS A CONTROLLED DOCUMENT.

DATE 10NOV2005

APPD K.Fruhwirth

CHK M.Pfeilschiffer

NAME PRODUCT SPEC

108-18513

APPLICATION SPEC

114-18148

WEIGHT

Customer Drawing

TE Connectivity

PRODUCT GROUP DRAWING FOR

Tabellenzeichnung fuer

AMP MCP2.8 LANCELESS

SIZE CAGE CODE DRAWING NO RESTRICTED TO

A1 00779 C=1719458