

| LOC | DIST | REVISIONS | | | | | |
|-----|------|-----------|-----|------------------------------|---------|-----|------|
| GP | 00 | P | LTR | DESCRIPTION | DATE | DWN | APVD |
| | | 0 | | RELEASED PER EC OS13-0288-05 | 29SEP05 | GP | JG |

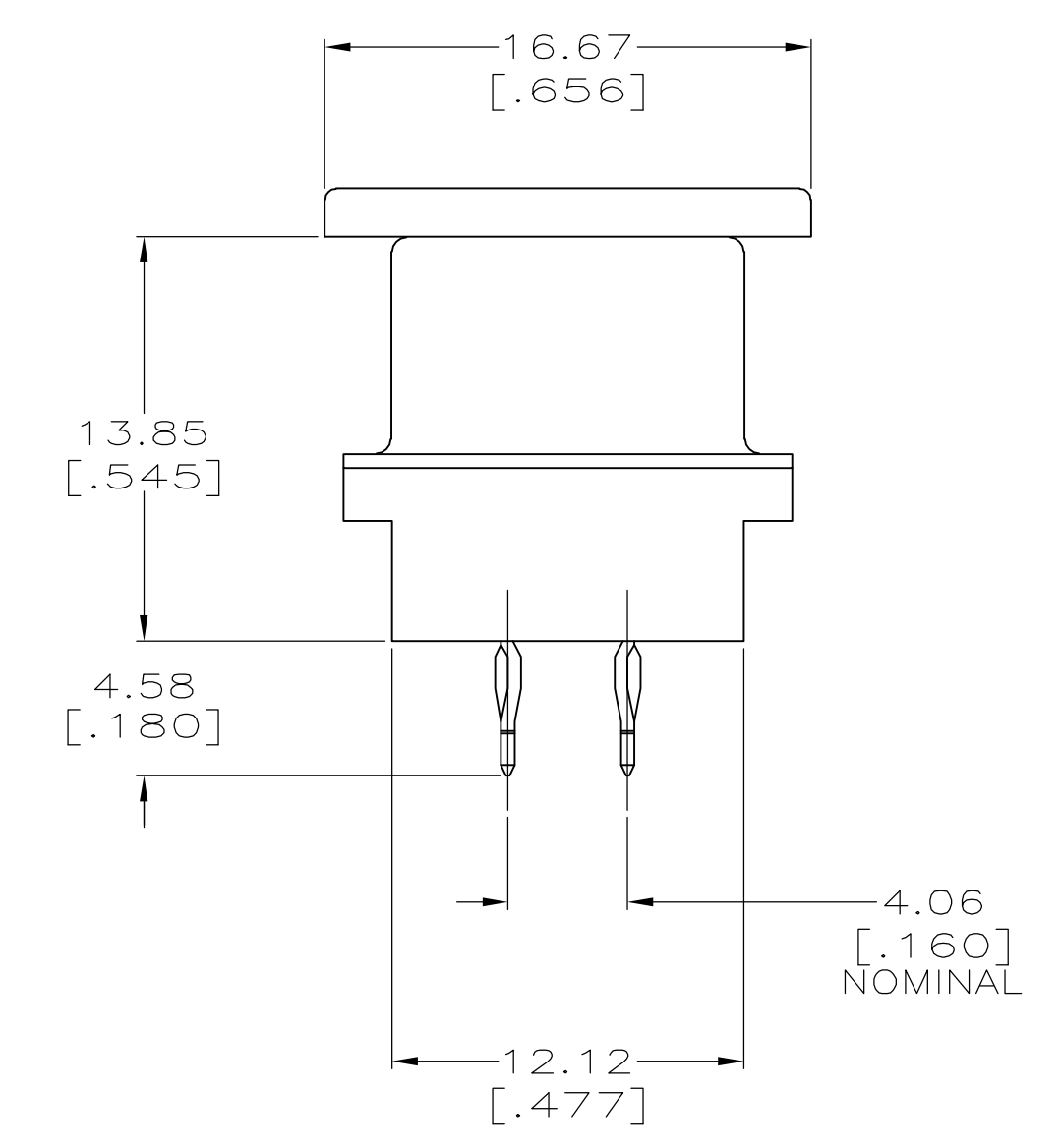

- △ DIMENSIONS ARE MAXIMUM UNLESS OTHERWISE SPECIFIED.
- △ MATERIAL: HOUSING - POLYESTER, BLACK. TERMINALS - COPPER ALLOY PLATED WITH 0.76 μm [.000030] MINIMUM GOLD ON MATING SURFACE AND 0.13 μm [.000005] MINIMUM GOLD FLASH ON ACTION PIN AREA OVER 1.27 μm [.000050] MINIMUM NICKEL UNDERPLATE OVER ENTIRE TERMINAL. RETAINER - POLYETHYLENE, NATURAL. SHIELD - CARBON STEEL, PLATED BRIGHT NICKEL 5.08 μm [.000200] MINIMUM. INSERTS - ZINC PLATED BRASS.
- 3. THE CONTACT SURFACES OF THE TERMINALS ARE COATED WITH LUBRICANT.
- △ OPTIONAL MOUNTING HOLE FOR SELF-TAPPING SCREW.
- △ "1" ON HOUSING INDICATES LOCATION OF TERMINAL 1.
- △ ALL PLATED-THRU HOLES SHALL BE PER AMP SPEC 115-6072.
- △ 50 LBS MINIMUM FORCE REQUIRED TO UNSEAT CONNECTOR FROM PRINTED CIRCUIT BOARD WITHOUT USE OF HARDWARE.
- 8. CENTER-TO-CENTER SPACING OF TERMINALS IS 2.16 [.085] NOMINAL.
- △ INSERTS SHALL WITHSTAND A 222 N [50 LB] PULL FORCE IN DIRECTION Y.
- △ RETAINER MUST REMAIN INSTALLED UNTIL AFTER CONNECTOR HAS BEEN INSERTED INTO PCB HOLES.

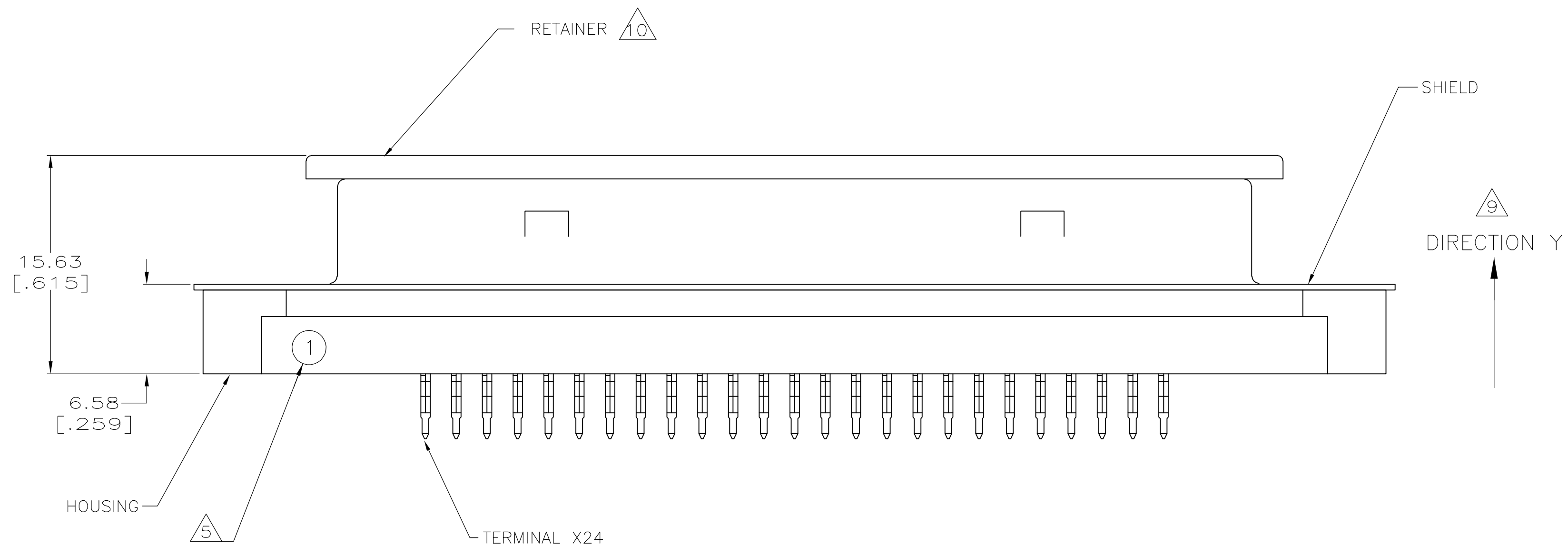
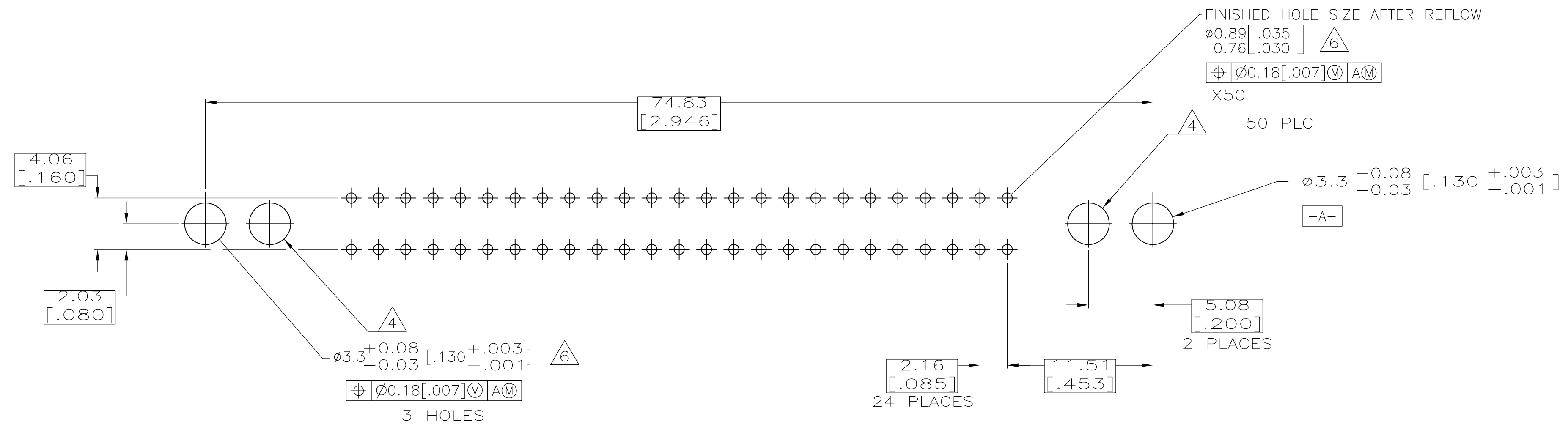
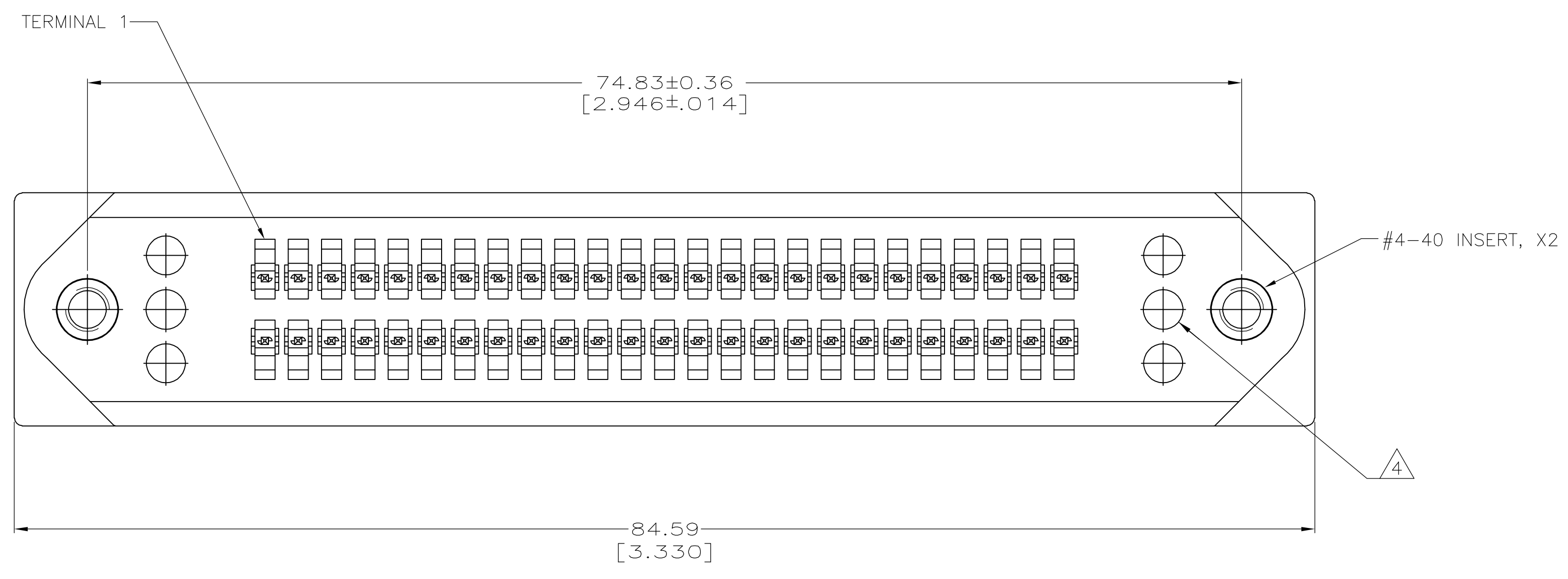

PRINTED CIRCUIT BOARD MOUNTING DIMENSIONS △△

5569286-1
PART NUMBER

| | | | | | |
|-----------------------------------------------------------------------------|--|--------------------------|--|-------------------------------------------------------------------------------------------|----------------------------------------------------------------------------|
| THIS DRAWING IS A CONTROLLED DOCUMENT. | | DWN: G.PETERS 29SEP05 | | Tyco Electronics Corporation Harrisburg, Pa 17105-3608 | |
| DIMENSIONS: mm | | CHK: W.MILLHIMES 29SEP05 | | NAME: M.WALMSLEY 29SEP05 | RECEPTACLE ASSEMBLY, 50 POSITION, WITH INSERT, SHIELDED, ACTION PIN, CHAMP |
| TOLERANCES UNLESS OTHERWISE SPECIFIED: | | PRODUCT SPEC: - | | APPLICATION SPEC: - | |
| 0 PLC ± - 1 PLC ± - 2 PLC ± - 3 PLC ± - 4 PLC ± - ANGLES ± - | | 1 △ 2 △ 3 △ 4 △ | | SIZE: A1 CAGE CODE: 00779 DRAWING NO: C=5569286 WEIGHT: - CUSTOMER DRAWING: - | |
| MATERIAL: △2 | | FINISH: △2 | | SCALE: 4:1 SHEET 1 OF 1 REV 0 | |