

THIS DRAWING IS UNPUBLISHED.				RELEASED FOR PUBLICATION		SEP. 1993.	
© COPYRIGHT 1993 BY TYCO ELECTRONICS CORPORATION. ALL RIGHTS RESERVED.				DIST		REVISED	
LOC		J		DESCRIPTION		E-CR-07-008620	
P		LTR		DATE		DWN	
F				17JUL2007		T.T	
APVD		T.T		APVD		T.F	

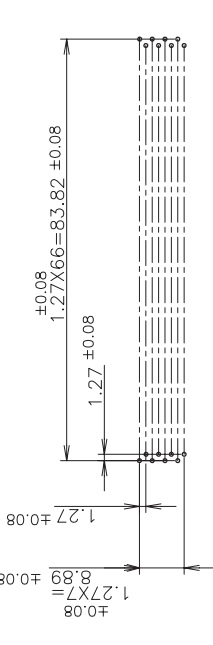

推奨基板寸法
RECOMMENDED P.C.BOARD DIM.
(コネクタ取付側)
(VIEW FROM CONN. SIDE)

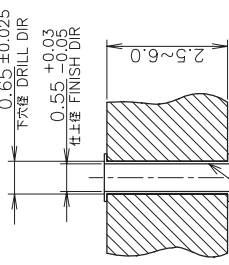

銅スルーホールめっき 25μm~50μm
Cu THROUGH HOLE PLATING 25μm~50μm

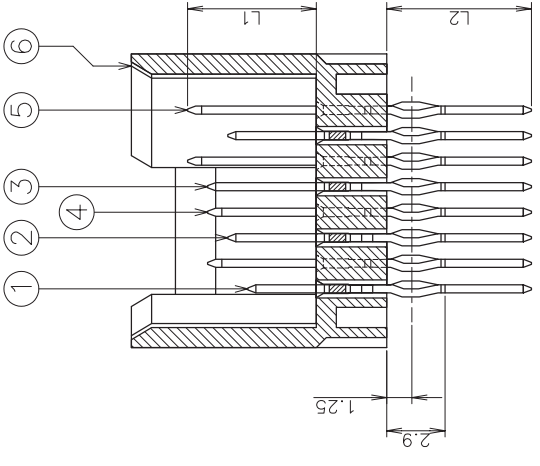
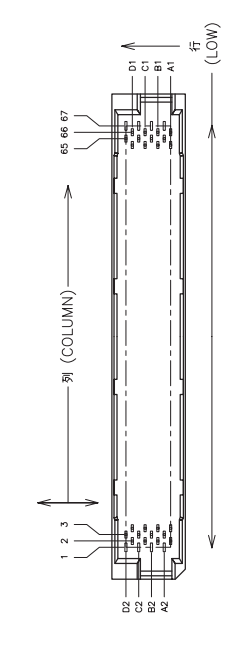
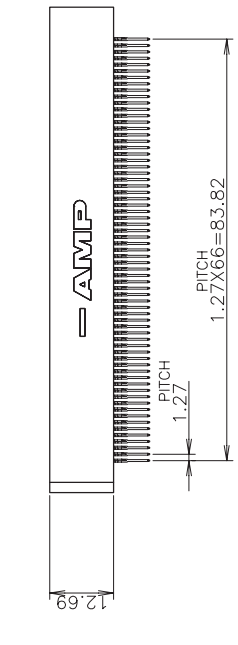
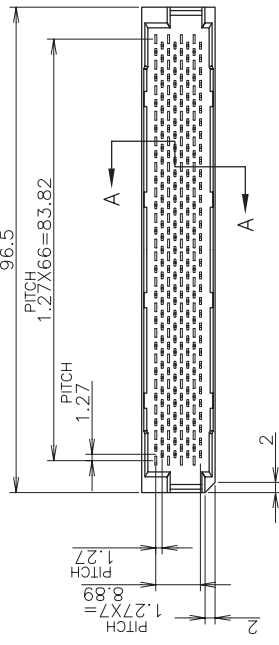

A-A (SCALE 4:1)

- 1 コンタクトの配置は別表による。
- 2 コンタクト保持力
シグナルコンタクト：800g/PIN 以上
グラウンドコンタクト：800g/PIN 以上
- 1 CONTACT LOCATION: SEE TABLE.
- 2 CONTACT RETENTION FORCE
SIGNAL CONTACT: 800g/PIN MIN.
GROUND CONTACT: 800g/PIN MIN.

⑥	ヘッター・ハウジング	HDR. HOUSING	ガラス入り熱可塑性ポリエステル樹脂 (黒)	GRASS FIELD THRW PLASTIC POLYESTER (BLACK)
⑤	タブ・ポスト (ロング)	TAB POST (LONG)	めっき仕様	ニッケル下地めっき 1.27μm MIN.
④	タブ・ポスト (ショート)	TAB POST (SHORT)	めっき仕様	ニッケル下地めっき 0.5μm MIN. アクション部: 金めっき 0.1μm MIN.
③	ピン・ポスト (ロング)	PIN POST (LONG)	COPPER ALLOY	FINISH UNDER Ni: 1.27μm MIN. CONTACT AREA Au 0.5μm MIN.
②	ピン・ポスト (ミドル)	PIN POST (MID)		ACTION AREA Au 0.1μm MIN.
①	ピン・ポスト (ショート)	PIN POST (SHORT)		
ITEM NO.		名称 / NAME		材質 / MATERIAL

THIS DRAWING IS A CONTROLLED DOCUMENT.		DWN	I.HASEGAWA	22SEP1993	Tyco Electronics Corporation	
		CHK	S.MANABE	27SEP1993	Kawasaki, Japan	
		APVD	S.MANABE	27SEP1993		
		PRODUCT SPEC	製品仕様書		NAME	
		ABSOLUTE SPEC	絶対仕様書		268P 196 SIGNAL HDR. ASSY	
		APPLIC. SPEC	取付管用規格		AMP Z-PACK STAGGERED 050U-II TYPE S	
DIMENSIONS: 単位: mm		0 PLC ±		SIZE		DRIVING NO
1 PLC ±		2 PLC ±		A3		番号
3 PLC ±		4 PLC ±		C=179374		SCALE
ANGLES FINISH 仕上				CUSTOMER DRAWING		尺度
SEE TABLE.		SEE TABLE.		SHEET		1 of 2
				REV		F

THIS DRAWING IS UNPUBLISHED.		RELEASED FOR PUBLICATION SEP. 1993.		LOC		DIST		REVISONS	
COPYRIGHT 1993 BY TYCO ELECTRONICS CORPORATION.		ALL RIGHTS RESERVED.		J		---		DESCRIPTION	
				---		---		DATE	
				---		---		DWN	
				---		---		APVD	
				---		---		SEE SHEET 1	

TAB POST (LONG)	6.4	72	1,5,9,13,17,21,25,29,33,35,39,43,47,51,55,59,63,67	72	1,5,9,13,17,21,25,29,33,35,39,43,47,51,55,59,63,67	36	D-2, B-2 行 C-2, A-2 行	1,5,9,13,17,21,25,29,33,35,39,43,47,51,55,59,63,67
TAB POST (SHORT)	5.4	0	NONE	0	NONE	36	C-2, A-2 行	1,5,9,13,17,21,25,29,33,35,39,43,47,51,55,59,63,67
PIN POST (LONG)	5.4	0	NONE	194	上下部のボジションを除く全極 OTHER ALL POSITION.	0	NONE	
PIN POST (MID)	4.4	196	全極列 (2-66) 及び ALL EVEN NO. COLUMN (2-66) AND	0	34列 A1, 34列 B1	196	全極列 (2-66) 及び ALL EVEN NO. COLUMN (2-66) AND	3,7,11,15,19,23,27,31,37,41,45,49,53,57,61,65
PIN POST (SHORT)	3.4	0	NONE	2	34列 A1, 34列 B1	0	NONE	
CONTACT NAME	L1		CONTACT LOCATION <COLUMN NO.> (L2=7.2) 1 7 9 3 7 4 - 1		CONTACT LOCATION <COLUMN NO.> (L2=7.2) 1 7 9 3 7 4 - 2 (タンズル塗布, ADD LUBRICATION.)	0	CONTACT LOCATION <COLUMN NO.> (L2=7.2) 1 7 9 3 7 4 - 3	
			(L2=7.2) 1 - 1 7 9 3 7 4 - 2 OBSOLETE					
			(L2=5.2) 2 - 1 7 9 3 7 4 - 2					
			(L2=5.2) 3 - 1 7 9 3 7 4 - 2 (タンズル塗布, ADD LUBRICATION.)					

THIS DRAWING IS A CONTROLLED DOCUMENT.		DWN		Tyco Electronics Tyco Electronics Corporation Kawasaki, Japan	
DIMENSIONS: 単位: 概 mm		CHK		NAME 名称	
TOLERANCES UNLESS OTHERWISE SPECIFIED: 一般公差		APVD		268P 196 SIGNAL HDR. ASSY	
0 PLC ±		PRODUCT SPEC		AMP Z-PACK STAGGERED 050J-II TYPE S	
1 PLC ±		製品規格		DRAWING NO	
2 PLC ±		APPLICATION SPEC		C=179374	
3 PLC ±		取付書用規格		SCALE 尺度	
4 PLC ±		WEIGHT		SHEET 2 of 2	
ANGLES FIMISH 仕上		MATERIAL 材料		REV F	
RESTRICTED TO		CUSTOMER DRAWING			