

NOTES:

- MATERIAL: COPPER ALLOY 151, 0.50mm THICK.
- PLATING:
OVERALL *TIN: 0.00254 MIN BRIGHT TIN
OVER 0.00127 MIN NICKEL.
SELECT GOLD: 0.00076 MIN. SELECT GOLD IN CONTACT AREA,
0.00127 MIN. SELECT *TIN IN CRIMP AREA, OVER 0.00127 MIN NICKEL.
SELECT SILVER: 0.00254 MIN. SELECT SILVER IN CONTACT AREA,
0.00254 MIN. SELECT *TIN IN CRIMP AREA, OVER 0.00127 MIN NICKEL.
- PRODUCT SPECIFICATION: PS-42815-001.
- PACKAGING INFORMATION: PK-42815-001.
- PART IS DESIGNED IN METRIC.
- TERMINALS FOR USE WITH STRANDED WIRE ONLY,
STRANDED TINNED WIRE IS RECOMMENDED.
- AFTER CRIMPING, THIS DIMENSION IS 3.55mm MINIMUM.
- CRIMP SPECIFICATION: 638301000.
- WHEN USING TIN-PLATED TERMINALS FOR APPLICATIONS
INVOLVING VIBRATION AND/OR THERMAL CYCLING,
MOLEX STRONGLY RECOMMENDS THE USE OF NYE LUBRICANT,
NYOGEL 760G, ON THE MATING AREA OF THE TERMINAL.
LUBRICANT SHOULD BE APPLIED AFTER THE TERMINALS ARE
INSERTED INTO THE HOUSING.
- PARTS CONFORM TO CLASS 'B' REQUIREMENT OF COSMETIC SPECPS-45499-002.
- REFER AS-42815-001 FOR TIN PLATED TERMINALS RECOMMENDED LUBRICATION PROCEDURE.

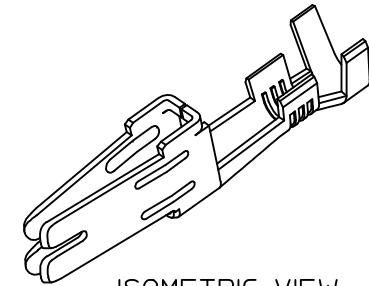

ISOMETRIC VIEW

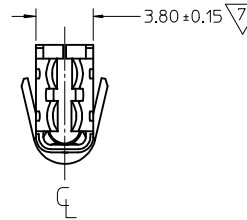
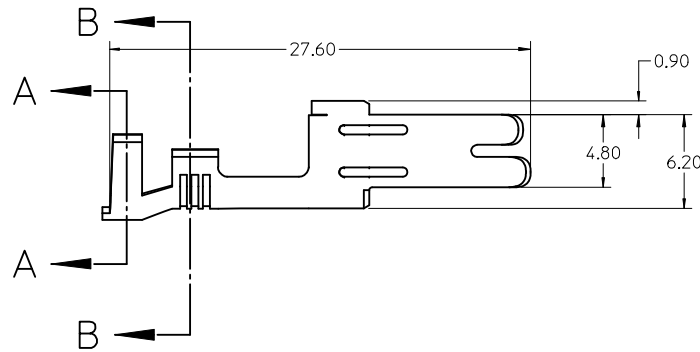
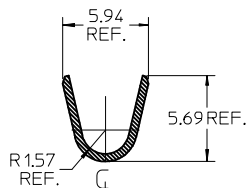

SECTION A-A
INSULATION CRIMP

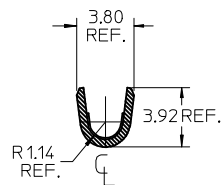

SECTION B-B
CONDUCTOR CRIMP

MATERIAL NO.	PLATING	STATUS
42815-0041	TIN	PLANNED FOR OBSOLESCENCE
42815-0042	SELECT GOLD	ACTIVE
42815-0144	SELECT SILVER	ACTIVE

NEW SILVER PLATING PART ADDED EC NO: UCP2015-2752 DRW: BR02 CHKD: APPR: KPRASAD	DESCRIPTION 2013/12/23 2015/02/09	QUALITY SYMBOLS ▽=0 ▽=0 ▽=0	GENERAL TOLERANCES (UNLESS SPECIFIED)		DIMENSION STYLE MM ONLY		SCALE 4:1	DESIGN UNITS METRIC	THIRD ANGLE PROJECTION
			mm	INCH	DRAWN BY MFIRLEJ	DATE 2002/05/15	TITLE MINIFIT SR. FEMALE CRIMP TERMINAL, 14-16 AWG SELECT GOLD & SILVER PLT		
			4 PLACES	± ---	± ---	CHECKED BY JCOMERC I <td>DATE 2002/05/15 <td rowspan="4"> </td> <td rowspan="4"> DOCUMENT NO. SD-42815-020 SHEET NO. 1 OF 1 </td> </td>	DATE 2002/05/15 <td rowspan="4"> </td> <td rowspan="4"> DOCUMENT NO. SD-42815-020 SHEET NO. 1 OF 1 </td>		DOCUMENT NO. SD-42815-020 SHEET NO. 1 OF 1
			3 PLACES	± ---	± ---	APPROVED BY JCOMERC I <td>DATE 2002/05/15</td>	DATE 2002/05/15		
			2 PLACES	± 0.25	± ---				
			1 PLACE	± 0.40	± ---				
			0 PLACE	±	±				
			ANGULAR ±1/2°		SEE CHART				
DRAFT WHERE APPLICABLE MUST REMAIN WITHIN DIMENSIONS			SIZE C		THIS DRAWING CONTAINS INFORMATION THAT IS PROPRIETARY TO MOLEX INCORPORATED AND SHOULD NOT BE USED WITHOUT WRITTEN PERMISSION				