

REV.	DATE	DESCRIPTION
NC	05/13/04	INITIAL RELEASE

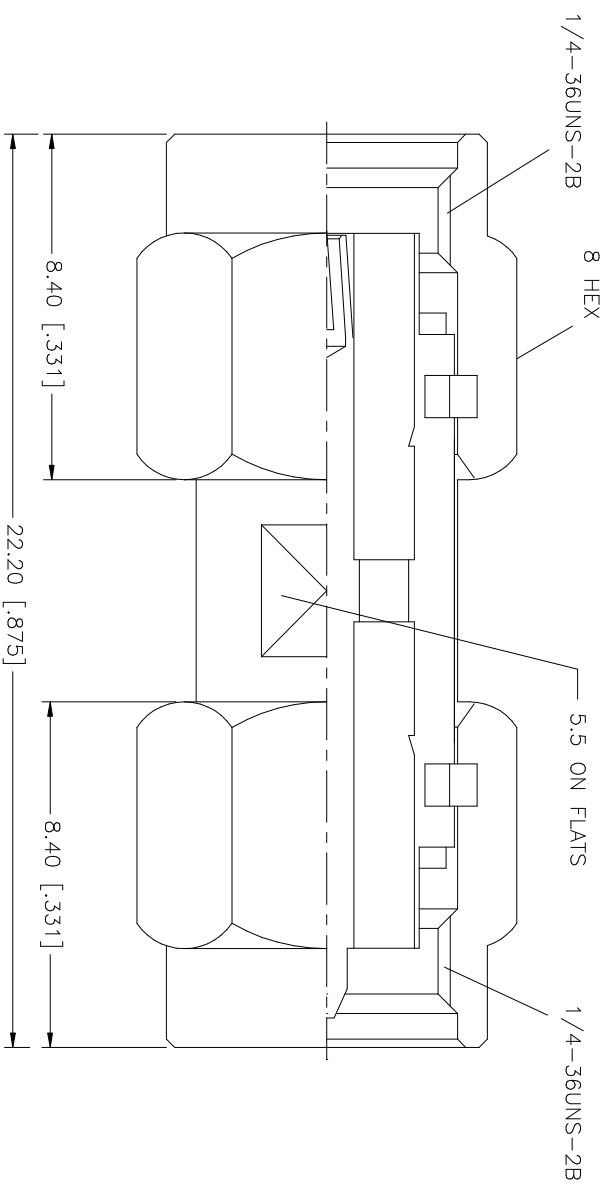

QTY	FINISH	MATERIAL	DESCRIPTION
1	GOLD	BER. COPPER	CONTACT PIN
1	NATURAL	TEFLON	INSULATOR
1	GOLD	BRASS	HOUSING/BODY

APPROVALS	DATE
DRAWN G.R.S.	05/13/04
CHECKED	
ISSUED	
SHEET 1 OF 1	

CAD FILE	C:/132/132168RP.DWG	DWG. NO.	132168RP.DWG	REV.	NC	SIZE	A	SCALE	NA
----------	---------------------	----------	--------------	------	----	------	---	-------	----

Amphenol Connex	
PART DESCRIPTION SMA PLUG TO SMA REVERSE POLARITY PLUG ADAPTER	
PART NO.	132168RP

UNLESS OTHERWISE SPECIFIED, DIMENSIONS ARE IN MILLIMETERS UNLESS IN THE TABLE ARE IN INCHES AND FOR CUSTOMER REFERENCE ONLY.	
UNLESS OTHERWISE SPECIFIED, TOLERANCES FOR MILLIMETERS ARE: 0.5 - 8mm ± 0.20mm 8 - 30mm ± 0.40mm 30 - 120mm ± 0.50mm	
UNLESS OTHERWISE SPECIFIED, TOLERANCES FOR INCHES ARE: .020 - .315 = ± 0.007" .315 - 1.180 = ± 0.015" 1.180 - 4.724 = ± 0.020"	
DO NOT SCALE DRAWING	